

# F5700 RFI Filters

Wide Band

SINGLE PHASE FILTERS



## Features:

- Ideal for VDE "B" and MIL-STD-461 Switching Power Supply Applications
- Very High Inductance Design with Differential Mode Choke to Provide Improved Performance Below 100KHz
- Wide-Band Insertion Loss >60dB from 10MHz to 1GHz
- Compact, Space-Efficient Package Available in 3 and 6Amp Ratings

## F5700 Simplified Schematic

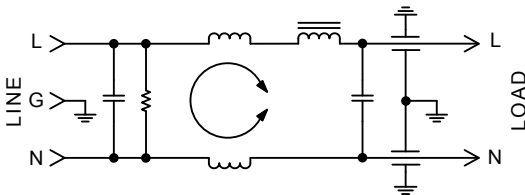

## Specifications:

**Rated Voltage:** 250VAC Maximum - 50/60 Hz

**Rated Current:** 115VAC 250VAC  
3A 2A  
6A 4A

**Current Overload:** 6X for 8 seconds

**Hi-Pot Test (1 min):**

Line to Ground 1400VDC  
Line to Line 1450VDC

**Insulation Resistance:**  $9 \times 10^9 \Omega$  at 100VDC

**Ambient Temperature:** 40°C Max. at rated current

**Humidity Range:** 0% to 95% R.H.

**Termination:**

C: IEC Receptacle  
G: Wire Wrap/Solder

**Maximum Leakage Current:**

Each Line to Ground **F5700**  
115VAC, 60Hz: 0.50mA  
250VAC, 60Hz: 1.20mA

**Agency Approvals:**



| Nominal Current Rating | Part Number | Termination Line/Load |
|------------------------|-------------|-----------------------|
| 3A                     | F5700CG03   | IEC/<br>Solder Tab    |
| 6A                     | F5700CG06   | IEC/<br>Solder Tab    |

**F5700 SERIES  
TYPICAL COMMON MODE  
INSERTION LOSS — dB  
(50 OHM CIRCUIT)**

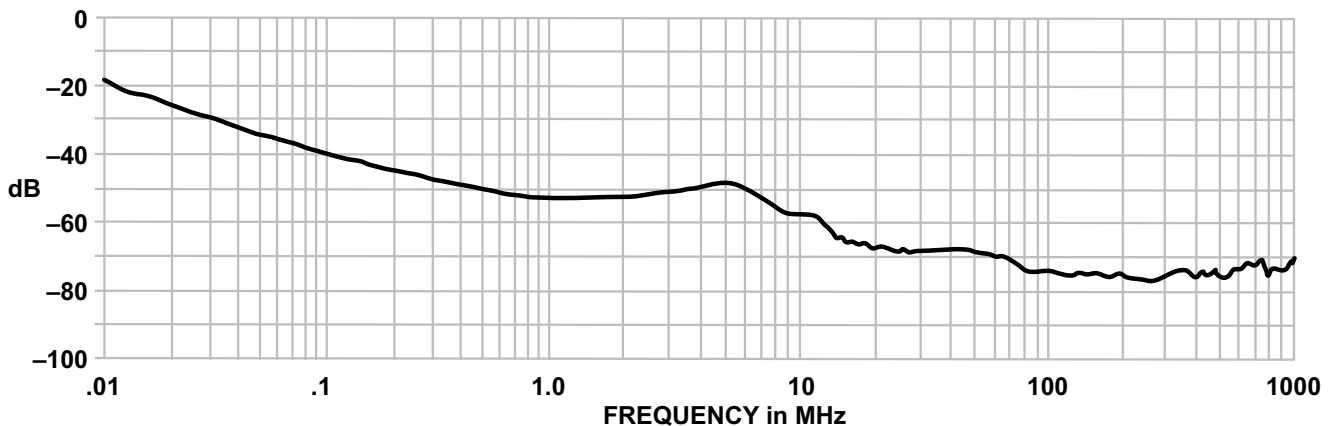

### F5700CG (3 and 6Amp) Dimensions

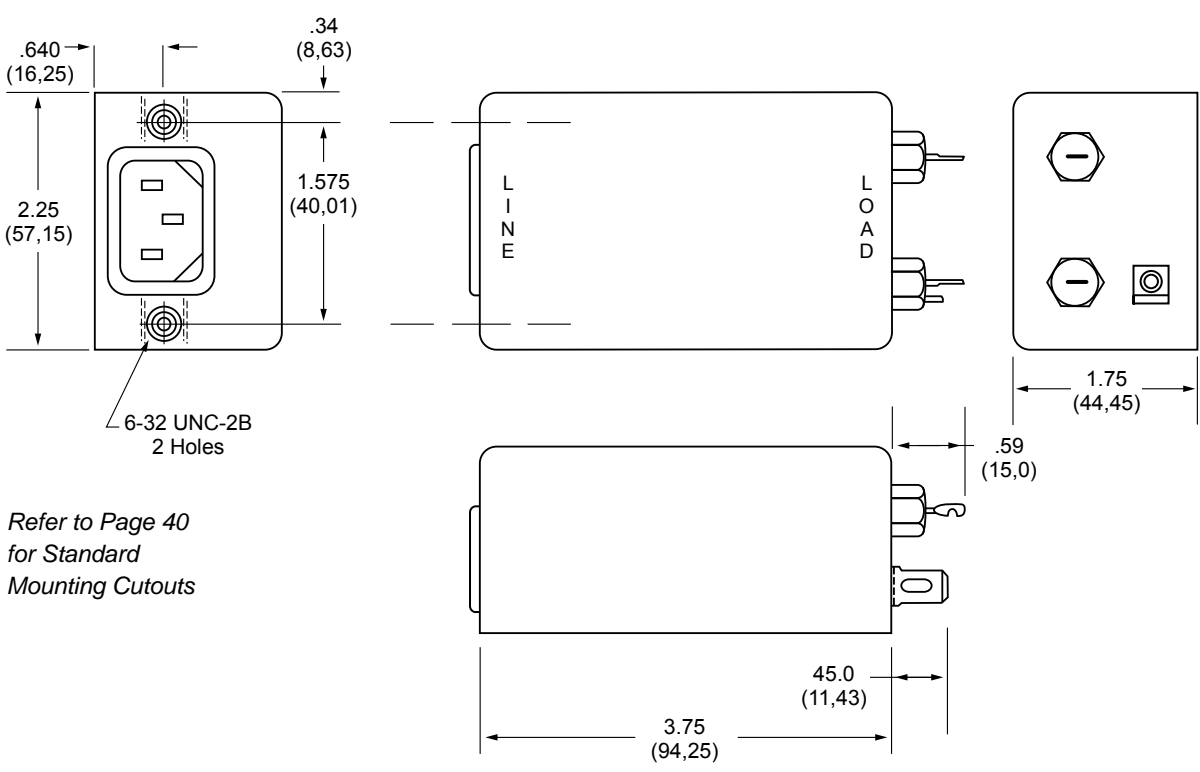

Refer to Page 40 for Standard Mounting Cutouts

### F5701CG (3 and 6Amp) Dimensions with attached mounting plate

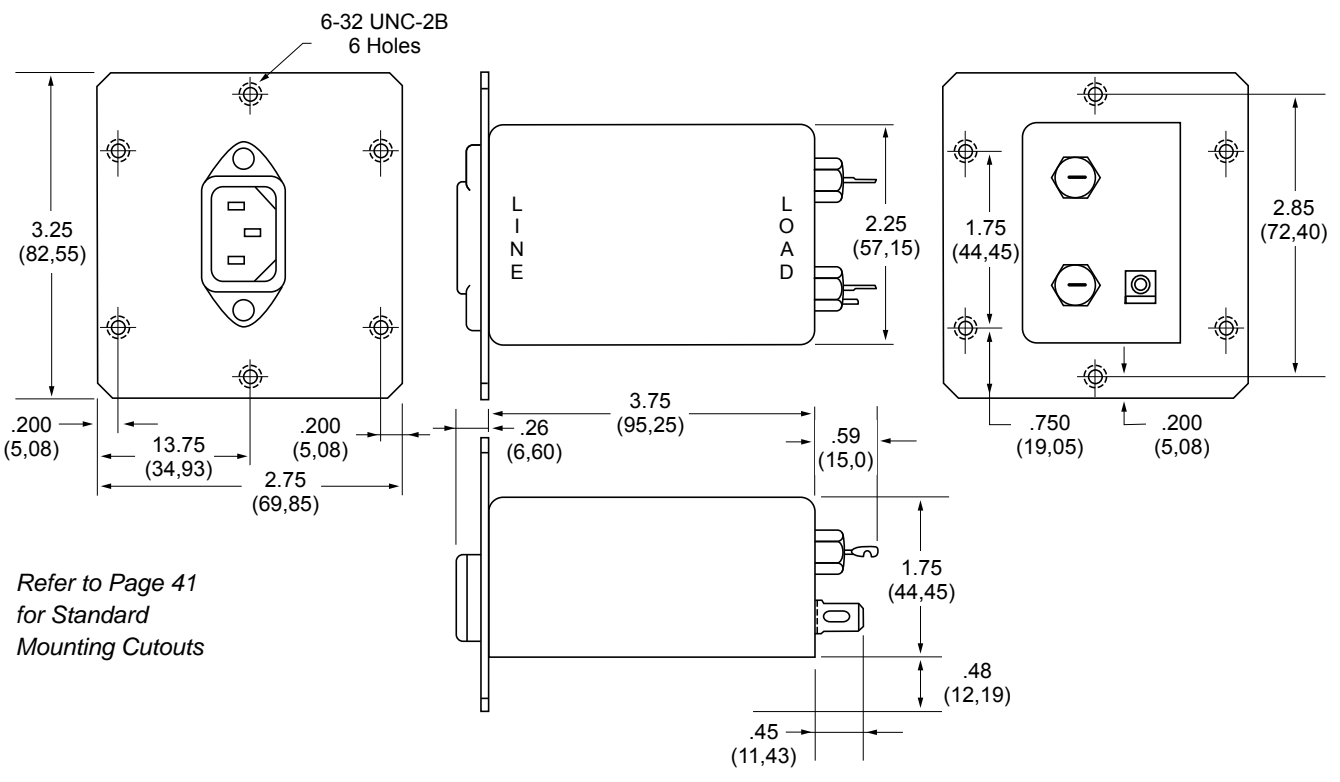

Refer to Page 41 for Standard Mounting Cutouts

Dimensions are in inches and millimeters unless otherwise specified. Values in parentheses are metric equivalents.



# Standard Mounting Cutouts

## F1200CA, F1300CA, F1400CA, F1500CA, F1600CA, F1700CA

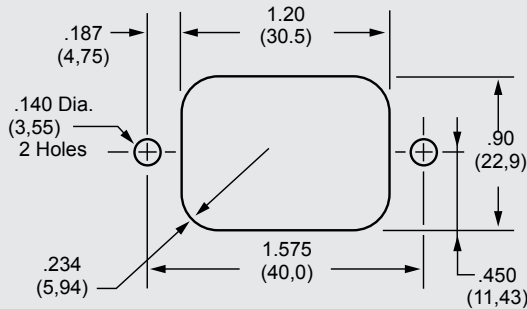

## F1500FA, F1600FA,

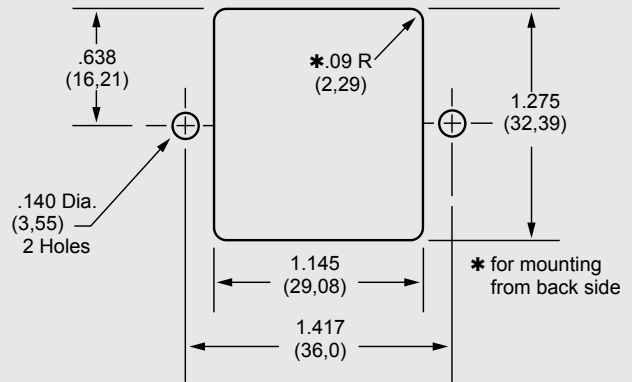

### How to Order

The Curtis part numbering system is made up of four elements. Each element denotes a specific requirement (mechanical or electrical) which, when properly sequenced, fully identifies the required catalog filter. As shown, the first five alpha/numeric characters denote the series type; the sixth character (alpha) denotes the type of line termination; the seventh character (alpha) denotes the type of load termination; the last two characters (numeric) denote the current rating.

Compose your part number as follows: Select the series required, add two alpha character for the line and load termination, followed by two numeric characters for the required current rating. For example, F1100AB06 completely identifies an F1100 series filter with quick connects on line side and wire leads on load side, with a 6-amp rating.

## F1300CP, F1600CP

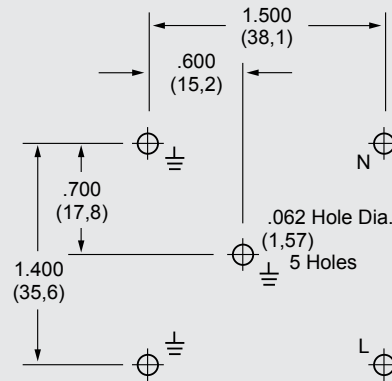

## F5500/5600/5700 SERIES

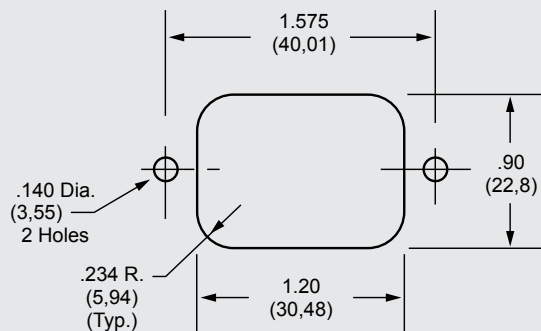

SINGLE PHASE FILTERS

| F1100  | X  | X  | X  |
|--|--|--|--|
| SERIES                                       | LINE TERMINATION   | LOAD TERMINATION   | CURRENT RATING   |
| PE = Power Entry<br>PM = Medical Power Entry | A = Quick Connects<br>B = Wire Leads<br>C = IEC Connector<br>D = Screw Terminals (20 & 30 amp only)<br>F = Fused IEC<br>P = Printed Circuit Pins<br>W = Dual Fused IEC<br>J = Switched IEC | A = Quick Connects<br>B = Wire Leads (20 & 30 amp only)<br>D = Screw Terminals<br>P = Printed Circuit Pins<br>S = Solder Tab | 01 = 1 Amp<br>03 = 3 Amps<br>06 = 6 Amps<br>10 = 10 Amps<br>15 = 15 Amps<br>20 = 20 Amps<br>30 = 30 Amps |



### F5100 SERIES

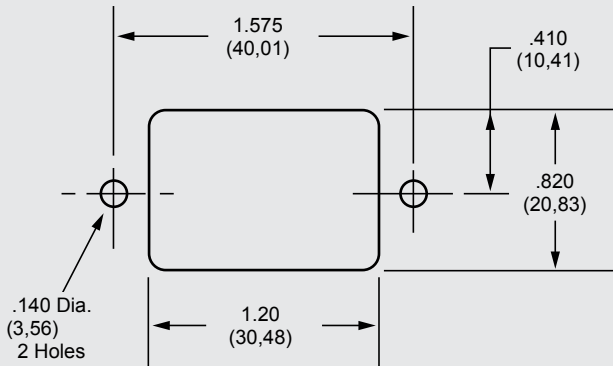

### F5200 SERIES

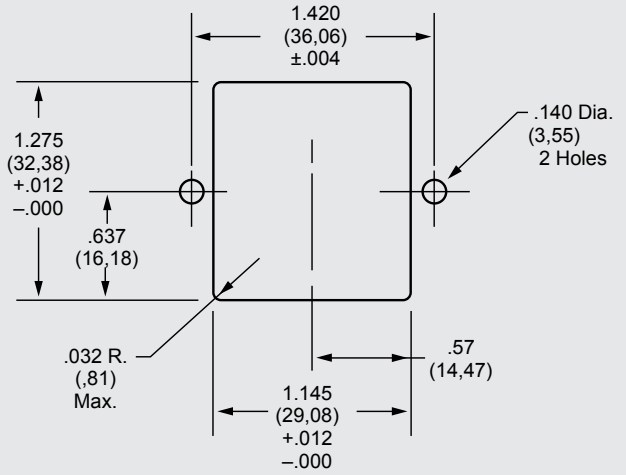

### F5101 SERIES

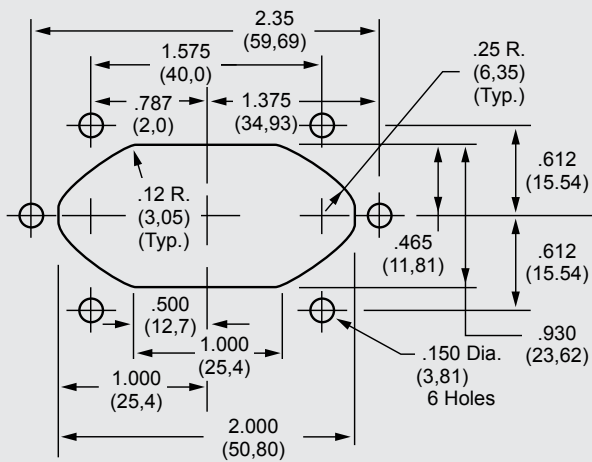

### F5201 SERIES

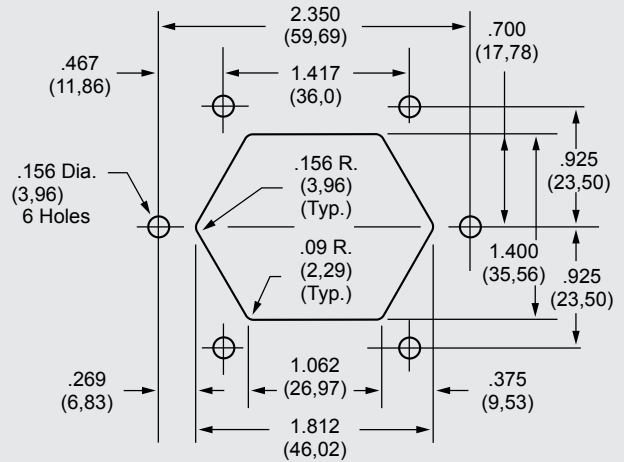

### F5501/5601/5701 SERIES

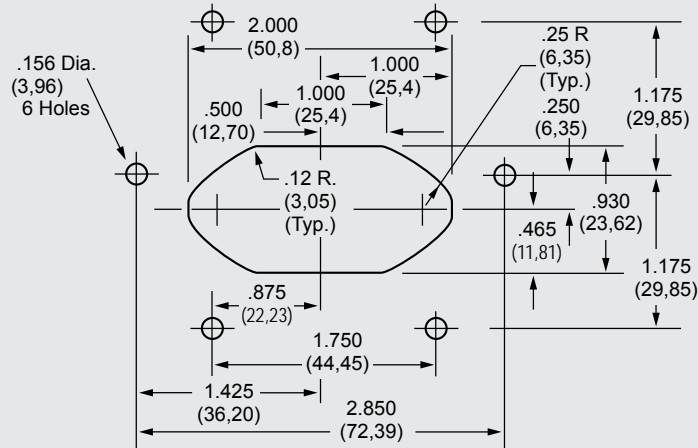

NOTE: Tolerance for all dimensions unless otherwise specified: .XXX three place ± .004, .XX two place ± 0.10

Dimensions are in inches and millimeters unless otherwise specified. Values in parentheses are metric equivalents.



**Curtis Industries**  
A Division of Powers Holdings, Inc.

1-800-657-0853