

F5600 RFI Filters

Wide Band

SINGLE PHASE FILTERS

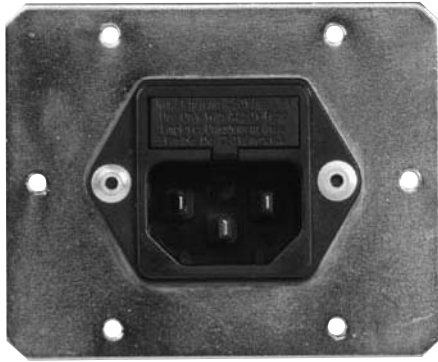

Features:

- Suited for FCC "B" and VDE "A" Switching Power Supply Applications
- High Inductance, Multi-Stage Design with High Common Mode and Differential Mode Insertion Loss for Switching Power Supply Emissions
- >70dB Insertion Loss from 200KHz to 1GHz
- Compact, Space-Efficient Package Available in 3 and 6Amp Ratings

Specifications:

Rated Voltage: 250VAC Maximum - 50/60 Hz

Rated Current: 115VAC 250VAC
 3A 1.5A
 6A 4A

Current Overload: 6X for 8 seconds

Hi-Pot Test (1 min):

Line to Ground 1400VDC
 Line to Line 1450VDC

Insulation Resistance: $9 \times 10^9 \Omega$ at 100VDC

Ambient Temperature: 40°C Max at rated current

Humidity Range: 0% to 95% R.H.

Termination:

- C: IEC Receptacle
- F: Fused IEC Receptacle
- G: Wire Wrap/Solder

Termination: Quick Connect

Maximum Leakage Current:

Each Line to Ground **F5600**
 115VAC, 60Hz: 0.50mA
 250VAC, 60Hz: 1.20mA

Agency Approvals:



Nominal Current Rating	Part Number	Termination Line/Load
3A	F5600CG03	IEC/Solder Tab
	F5600FG03	Fused IEC/Solder Tab
6A	F5600CG06	IEC/Solder Tab
	F5600FG06	Fused IEC/Solder Tab

F5600 Simplified Schematic

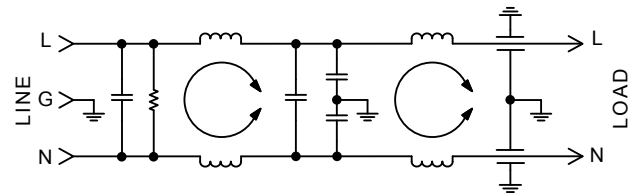

**F5600 SERIES
 TYPICAL COMMON MODE
 INSERTION LOSS — dB
 (50 OHM CIRCUIT)**

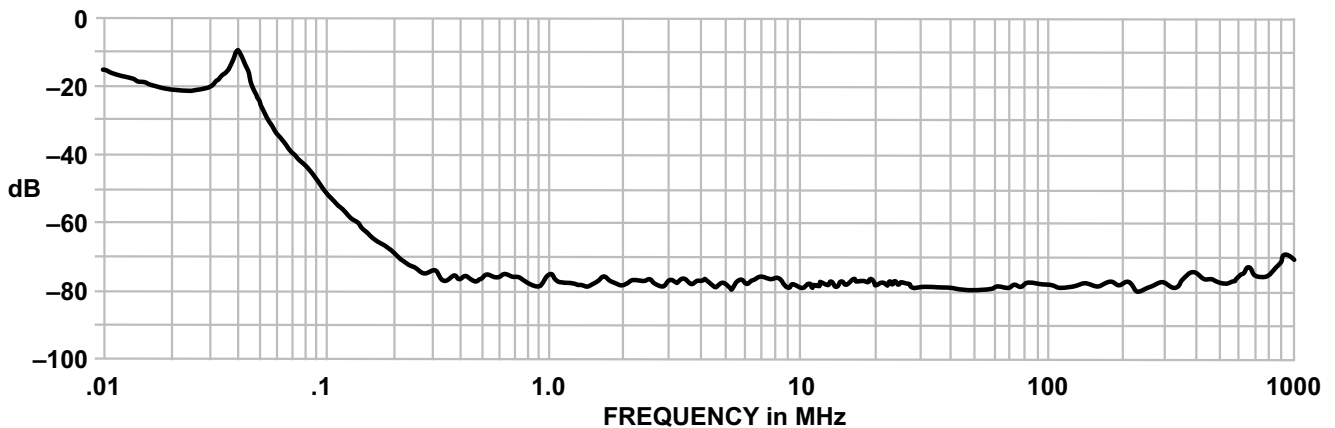

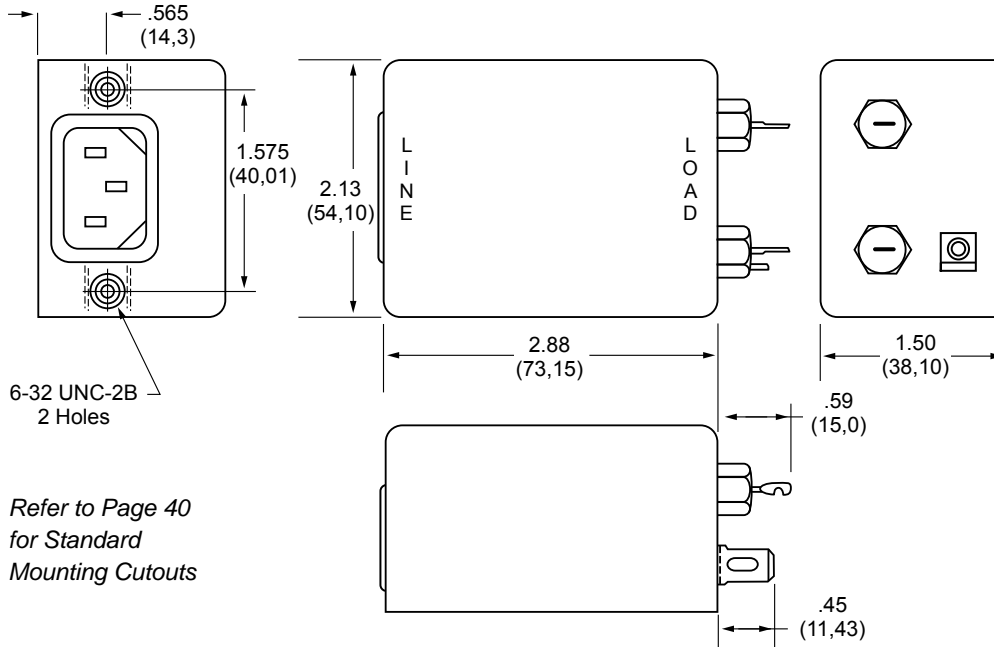
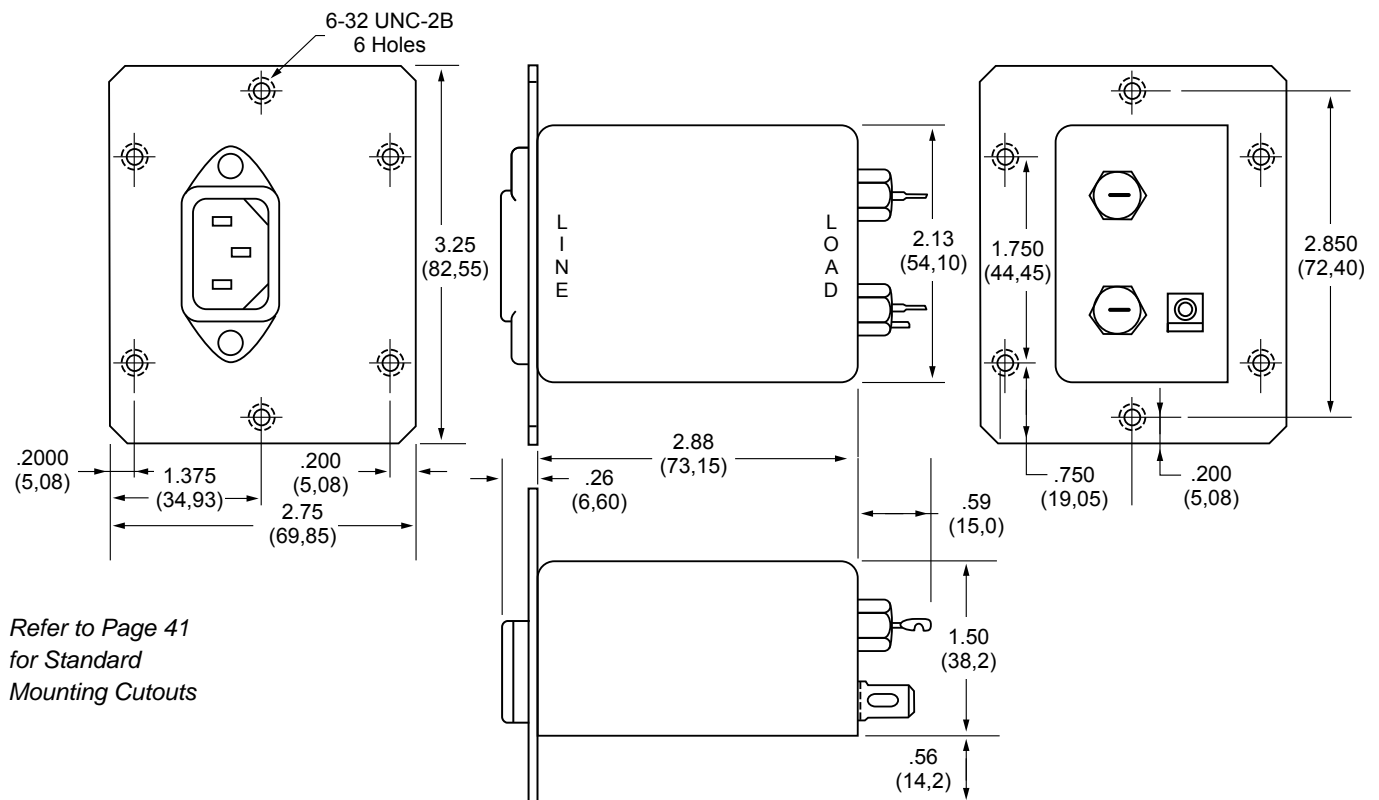
F5600CG (3 and 6Amp) Dimensions**F5601CG (3 and 6Amp) Dimensions with attached mounting plate**

Standard Mounting Cutouts

F1200CA, F1300CA, F1400CA, F1500CA, F1600CA, F1700CA

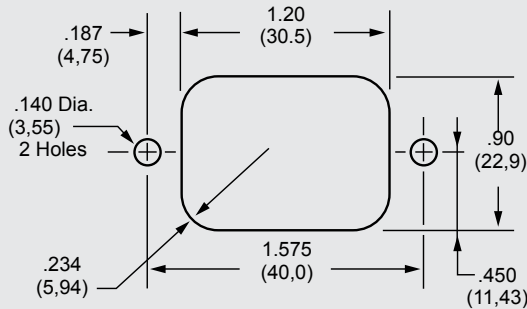

F1500FA, F1600FA,

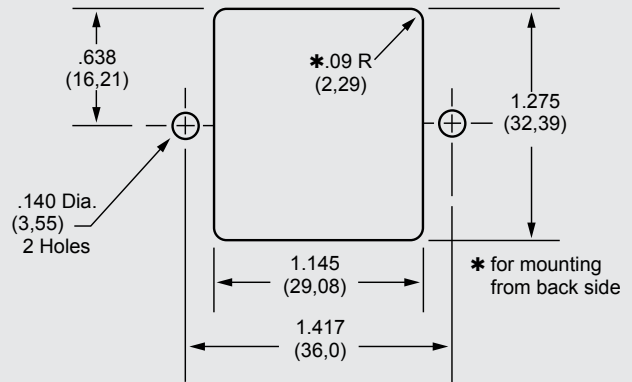

How to Order

The Curtis part numbering system is made up of four elements. Each element denotes a specific requirement (mechanical or electrical) which, when properly sequenced, fully identifies the required catalog filter. As shown, the first five alpha/numeric characters denote the series type; the sixth character (alpha) denotes the type of line termination; the seventh character (alpha) denotes the type of load termination; the last two characters (numeric) denote the current rating.

Compose your part number as follows: Select the series required, add two alpha character for the line and load termination, followed by two numeric characters for the required current rating. For example, F1100AB06 completely identifies an F1100 series filter with quick connects on line side and wire leads on load side, with a 6-amp rating.

F1300CP, F1600CP

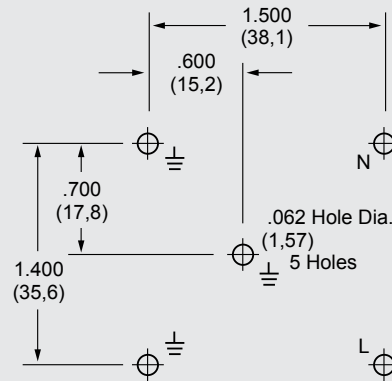

F5500/5600/5700 SERIES

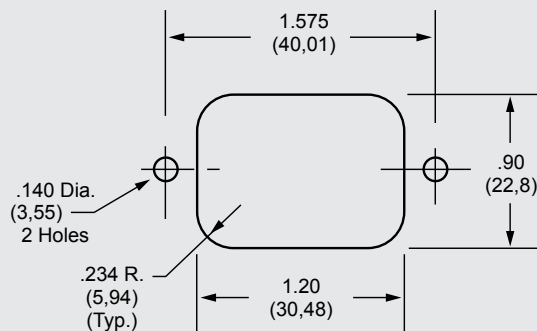

SINGLE PHASE FILTERS

F1100	X	X	X
SERIES	LINE TERMINATION	LOAD TERMINATION	CURRENT RATING
PE = Power Entry PM = Medical Power Entry	A = Quick Connects B = Wire Leads C = IEC Connector D = Screw Terminals (20 & 30 amp only) F = Fused IEC P = Printed Circuit Pins W = Dual Fused IEC J = Switched IEC	A = Quick Connects B = Wire Leads (20 & 30 amp only) D = Screw Terminals P = Printed Circuit Pins S = Solder Tab	01 = 1 Amp 03 = 3 Amps 06 = 6 Amps 10 = 10 Amps 15 = 15 Amps 20 = 20 Amps 30 = 30 Amps



F5100 SERIES

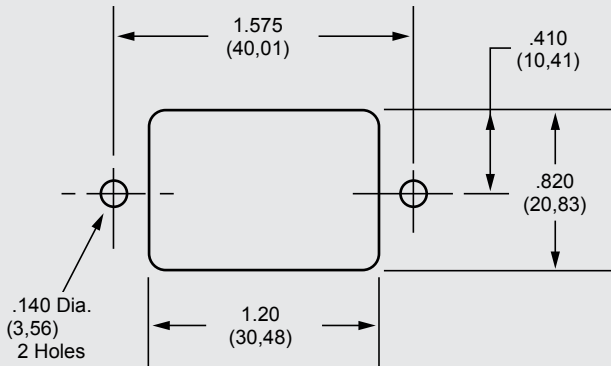

F5200 SERIES

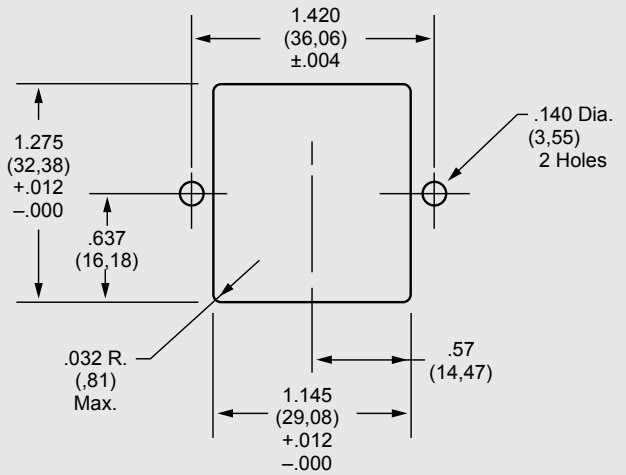

F5101 SERIES

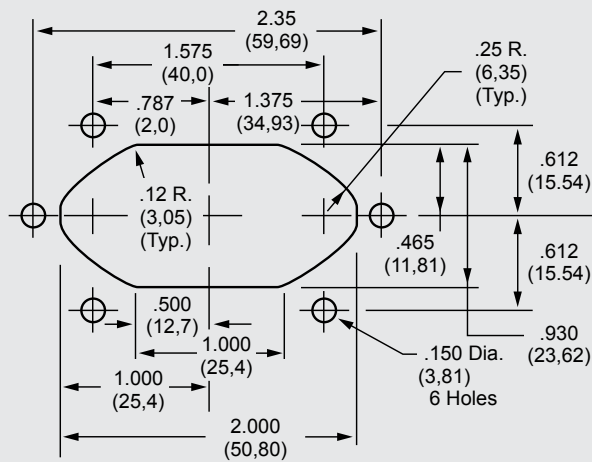

F5201 SERIES

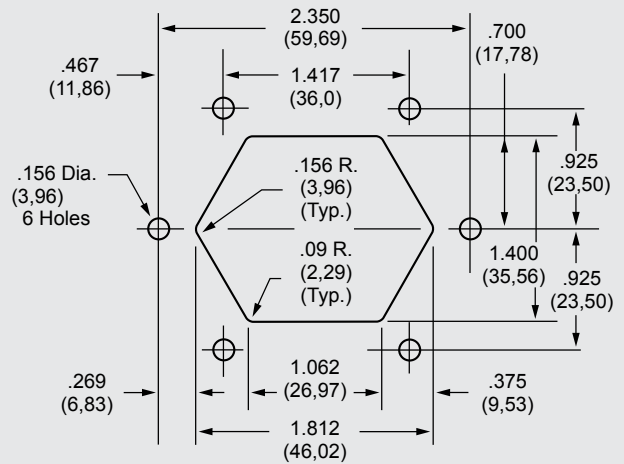

F5501/5601/5701 SERIES

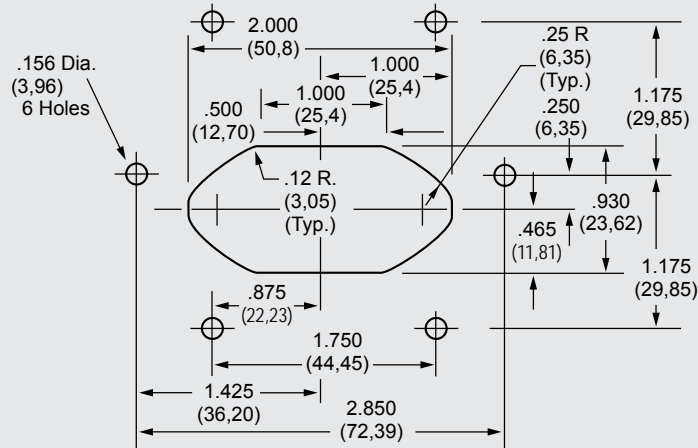

NOTE: Tolerance for all dimensions unless otherwise specified: .XXX three place ± .004, .XX two place ± 0.10

Dimensions are in inches and millimeters unless otherwise specified. Values in parentheses are metric equivalents.



Curtis Industries
A Division of Powers Holdings, Inc.

1-800-657-0853