



TRI-MAG, Inc.
 your POWER Specialists

1601 N. CLANCY CT. • VISALIA, CA 93291
 (559) 651-2222 • FAX (559) 651-0188
<http://www.tri-mag.com>
 sales@tri-mag.com

UV440 SERIES

40 Watt

UNIVERSAL INPUT

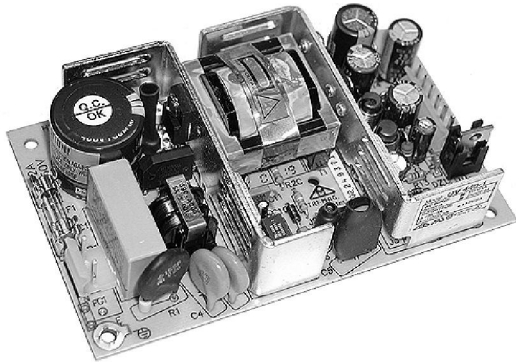

GENERAL SPECIFICATIONS

Input Voltage..... 85VAC to 264VAC
 or 120VDC to 350VDC
 Input Frequency..... 47Hz to 63Hz
 Inrush Current (cold)..... 30A @ 115VAC
 60A @ 230VAC
 Operating Temperature..... 0 to 50°C
 Storage Temperature..... - 20°C to 85°C
 Cooling..... Free Air Convection
 Efficiency..... 75% Typical
 Holdup Time..... 16ms at 115VAC
 Overvoltage Type..... Crowbar
 Trip Point, 6.2V ± 0.4V
 or Rated Output +2V
 Overload Protection..... Foldback
 at 150% load
 Output # 1 Voltage Adjustable..... ±10%
 Safety:
 Designed in full compliance with..... UL 60950-1
 CSA 22.2 No. 60950-1
 EN60950
 EMI..... Meet FCC Class "B"

DESCRIPTION

Tri-Mag, Inc. UV440 Series, these 40 watt switchers feature small size, low cost, high efficiency with universal input ranging from 85 VAC to 264 VAC without jumpers. Both single output and multiple output models are available. The UV440 Series is designed in full compliance to UL 1950CSA22.2 #234, and VDE EN60950.

FEATURES

- 80 TO 264VAC Universal Input
- Innovative Mosfet Design
- Low Cost
- High Efficiency
- 100% Hi-Pot Test
- 100% Cycling On-Off Burn-In Test
- Built-on Line Filter to Meet FCC Class B

APPLICATIONS

- Hard Disk Subsystems
- External Floppy Disk Systems
- External Tape Back-Up Systems
- Terminal Systems
- Modems
- Printers & Plotters

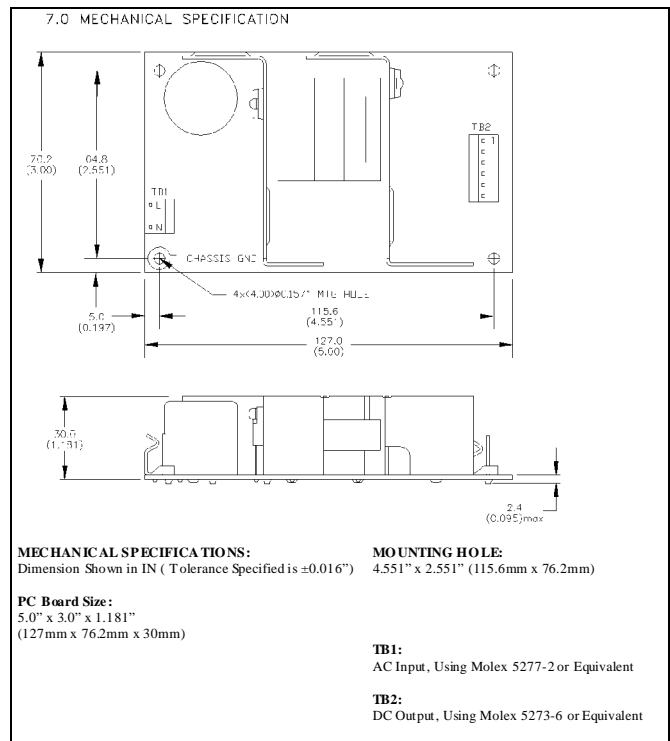
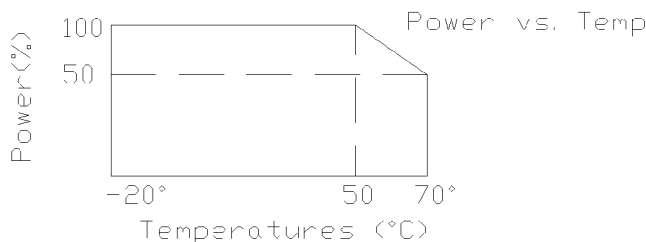



1601 N. CLANCY CT. • VISALIA, CA 93291
 (559) 651-2222 • FAX (559) 651-0188
<http://www.tri-mag.com>
sales@tri-mag.com

UV440 SERIES 40 WATT— PIN ASSIGNMENT

Pin	1	2	3	4	5	6	7	8
UV440-1	+12V	+5V	+5V	COM	COM	-12V	-	-
UV440-2	+15V	+5V	+5V	COM	COM	-15V	-	-
UV440-3	+12V	+5V	+5V	COM	COM	-5V	-	-
UV440-4	+5V	+5V	+5V	COM	COM	COM	-	-
UV440-5	+12V	+12V	+12V	COM	COM	COM	-	-
UV440-6	+15V	+15V	+15V	COM	COM	COM	-	-
UV440-7	+24V	+24V	+24V	COM	COM	COM	-	-
UV440-12	+12V	+5V	+5V	COM	COM	N/C	-	-
UV440-13	+12V	+12V	COM	COM	-12V	-12V	-	-
UV440-14	+48V	+48V	+48V	COM	COM	COM	-	-
UV440-17	3.3V	3.3V	COM	COM	COM	COM	+5V	+5V

UV440 SERIES 40 WATT— OUTPUT SPECIFICATIONS

Model	Voltage (Vdc)	Load (A)			Tolerance ±	Ripple & Noise	Regulation	
		Min.	Rate	Peak			Line	Load
UV440-1	+5V	0	3.0	6.0	1%	50 mV	1%	1%
	+12V	0	2.0	4.0	3%	120 mV	2%	3%
	-12V	0	0.3	0.5	3%	120 mV	3%	5%
UV440-2	+5V	0	3.0	5.0	1%	50 mV	1%	1%
	+15V	0	1.5	3.0	3%	150 mV	2%	3%
	-15V	0	0.3	0.5	3%	150 mV	3%	5%
UV440-3	+5V	0	3.0	6.0	1%	50 mV	1%	3%
	+12V	0	2.0	4.0	5%	100 mV	2%	3%
	-5V	0	0.3	0.5	5%	100 mV	3%	5%
UV440-4	+5V	0	8.0	10.0	1%	50 mV	1%	1%
UV440-5	+12V	0	3.3	5.0	1%	100 mV	1%	1%
UV440-6	+15V	0	2.6	4.0	1%	100 mV	1%	1%
UV440-7	+24V	0	1.7	2.5	1%	240 mV	1%	1%
UV440-12	+5V	0	3.0	3.0	1%	50 mV	1%	1%
	+12V	0	2.0	5.5	5%	120 mV	1%	4%
UV440-13	+12V	0	1.6	2.5	1%	100 mV	1%	1%
	-12V	0	1.6	2.5	3%	100 mV	1%	5%
UV440-14	+48V	0	0.83	0.85	1%	150 mV	1%	1%
UV440-17	+5V	0	5.0	6.0	1%	50 mV	1%	1%
	+3.3V	0	4.0	5.0	1%	50 mV	1%	1%